



24VDC

turbo



# BULL1224 TURBO

## COMMERCIAL USE

control unit with incorporated receiver and virtual encoder  
oil lubricated reductions  
personalised release key  
built-in battery charger

**up to 1200 kg****24 Vdc** | intensive use

- Fast 24 VDC geared motor for intensive use with oil lubricated reductions, control unit equipped with switching power supply (115/230 VAC) that permits reduced power use and long lifespan of the actuator
- The control unit, located on the top of the motor, facilitates wiring operations
- The virtual encoder allows proper management of the slowing-down phases, movement tracking (STC system), and torque management in relation to the position of the gate, which guarantees maximum safety
- Self-programming with transmitter can be activated at the first installation. Practical cableguides
- **Maximum performance and speed (24 m/min with 1200 kg)**
- Anti-crushing system with amperometric obstacle detection
- Safety sensor that stops the motor power supply during release operations
- Designed for connection to the X.BE module to integrate the device into KNX home automation systems
- Convenient compartment for 2 mod. DA.BT6 7 Ah batteries
- Option to operate opposed sliding gates using the SIS accessory
- Version available with magnetic limit switches (BULL1224 TURBO.S)
- Steel anti-vandal protective casing (optional)



## CONTROL UNITS:

**BULL1224 TURBO** — CP.B24 TURBO**BULL1224 TURBO.S** — CP.B24 TURBO

Foundation plate with anchor bolts included.  
Motor and floor fixing distance 269x106 mm, no. 4 Ø 12 mm.

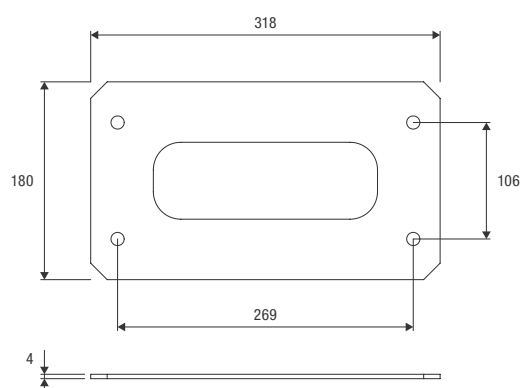
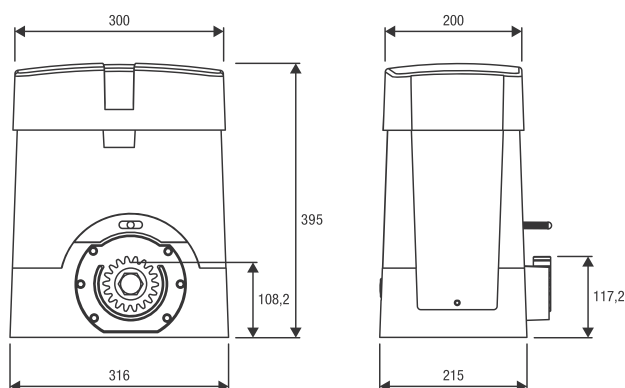

**RI.M4F**

M4 rack, to weld or attach with screws, 30x12x1000 mm slotted and galvanised. Supplied with M6 screws and threaded spacers.  
**Package of 4 pcs.**

**RI.M4F2**

M4 rack, to weld or attach with screws, 30x12x2000 mm slotted and galvanised. Supplied with M6 screws and threaded spacers.  
**Package of 1 pc.**

**RI.M4Z**

M4 galvanised rack to weld 22x22x2000 mm.  
**Package of 1 pc.**

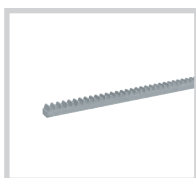
**RI.M4ZF**

Galvanised slotted M4 rack 22x22x2010 mm for fastening to the side with the teeth. Supplied with M6 screws.  
**Package of 1 pc.**

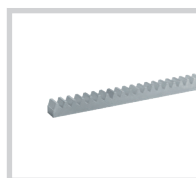
**RI.M6Z**

M6 galvanised rack to weld 30x30x2000 mm. Requires pinion RI.P6.  
**Package of 1 pc.**

**RI.P6**

M6 gear, it needs the rack RI.M6Z.

**BULL.PI**

Raised foundation plate. Height 32 mm. Floor fixing distance 280x170 mm, no. 4 Ø 11 mm. External dimensions 335x220 mm.

**BULL.CA**

Anti-vandal casing. Only for models with spring-loaded limit switches.

**RF.SUN**

Battery-operated device recharged by means of a photovoltaic panel applied on a mobile edge.

**RF**

Device with a non rechargeable battery, with guaranteed duration 2 years.

**SC.RF**

Device powered at 12/24 Vdc with self-test function and 2 outputs for connection to the electronic control units.

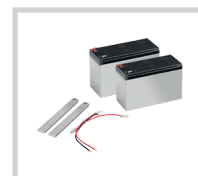
**BT6.BAT**

1.2 Ah battery kit with bracket and cable.

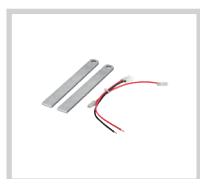
**BULL1224T.CB**

Kit composed of cables and brackets for batteries installation.  
**Pack of 5 pieces.**

**SIS**

Quick connection electronic board that allows synchronised movement of 2 automation devices (opposed sliding gates). One board for each motor is necessary.

**AUTOMATISMI BENINCÀ SpA** • Via del Capitello, 45 • 36066 Sandrigo (VI) ITALY • T +39 0444 751030 • sales@beninca.com

TECHNICAL DATA	BULL1224 TURBO	BULL1224 TURBO.S
Power supply	115 Vac / 230 Vac (50-60Hz)	115 Vac / 230 Vac (50-60Hz)
Motor supply	24 Vdc	24 Vdc
Max absorbed current	5 / 3 A	5 / 3 A
Max Thrust	550 N	550 N
Opening speed	12.5 ÷ 24 m/min	12.5 ÷ 24 m/min
Duty cycle	80%*	80%*
Protection level	IP44	IP44
Magnetic limit switches	NO	YES
Operating temperature	-20°C /+50°C	-20°C /+50°C
Max gate weight	1200 kg	1200 kg
Driving gear for rack	M4 Z18	M4 Z18
Weight	17.3 kg	17.4 kg
Items no. per pallet	20	20

\* In extreme operating conditions (environment T 50°C, speed 24 m/min, gate weight 1200 kg) the cycle falls to 40%